

**Boylan Environmental Consultants, Inc.**  
 Wetland & Wildlife Surveys, Environmental Permitting, & Impact Assessments

11000 Metro Parkway, Suite 4  
 Fort Myers, FL 33966  
 Phone: (239)418-0671  
 Fax: (239)418-0672

**COLONIAL PLANTATION DEALERSHIP**

LOCATION MAP

Created by:	Date:	SEC/RW/FNG	Exhibit Number
BKM	12/1/14	6/458/25E	
Drawn by:	Date:	Category	
BKM	12/1/14	Location Map	
Project Number:		County	
2014-52		Lee	

C:\Users\Brianna\AppData\Local\Temp\MapPublic\36780\Brianna\_Marys.dwg Tab: Aerial Dec 01, 2013 - 10:00am Plotted by: Brianna



**NOTES:**  
 Aerial photographs were acquired through Lee County Property Appraiser's office with a flight date of December, 2013.

Category	Drawn By:	Date:	Scale:
Aerial	B.K.M.	12/1/14	1" = 150'
Agency	Job Number		County
---	2014-51		Lee
App/Permit No.	Revision		S/T/R
***			6/45S/25E

**Colonial Plantation  
 Dealership**  
 2013 Aerial With Boundary

11000 Metro Parkway  
 Suite 4,  
 Ft. Myers, FL 33966  
 Phone: (239) 418-0671  
 Fax: (239) 418-0672  
 www.boylanenv.com





C:\Users\Bhraman\appdata\local\temp\AcPublish\2014\110625\110625\_MetroPark\_Aerial\_FLUCFCS\_Map\_Mar 25, 2015\_110625\_MetroPark.dwg: Bhaman



**LEGEND**

**Wetlands**  
(1.34± Ac.)

**Other Surface Waters**(1.21± Ac.)

**NOTES:**

FLUCFCS lines estimated from 1"=200' aerial photographs and locations approximated.

FLUCFCS per Florida Land Use, Cover and Forms Classification System (FLUCFCS) (FDDT 1999).

Aerial photographs were acquired through Lee County Property Appraiser's office with a flight date of December, 2013.

FLUCFCS Legend			
FLUCFCS CODE	COMMUNITY	TOTAL	%
190	Open Land	7.24± Ac	73.95%
211 H	Improved Pasture, Hydric	0.47± Ac	4.80%
500	Water	1.21± Ac	12.36%
624 E3	Cypress/Pine/Cabbage Palm	0.87± Ac	8.89%
<b>Total</b>		<b>9.79± Ac</b>	<b>100%</b>

Category	Drawn by:	Date:	Scale:
FLUCFCS	B.K.M.	3/25/15	1" = 150'
Agency	Job Number	County	
---	2014-52	Lee	
App/Permit No.	Revision	S/T/R	
***			6/45S/25E

**Colonial Plantation  
Dealership  
Aerial FLUCFCS Map**

11000 Metro Parkway  
Suite 4,  
Ft. Myers, FL 33966  
Phone: (239) 418-0671  
Fax: (239) 418-0672  
www.boylanenv.com



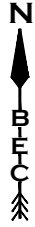

Scale: 1" = 150'

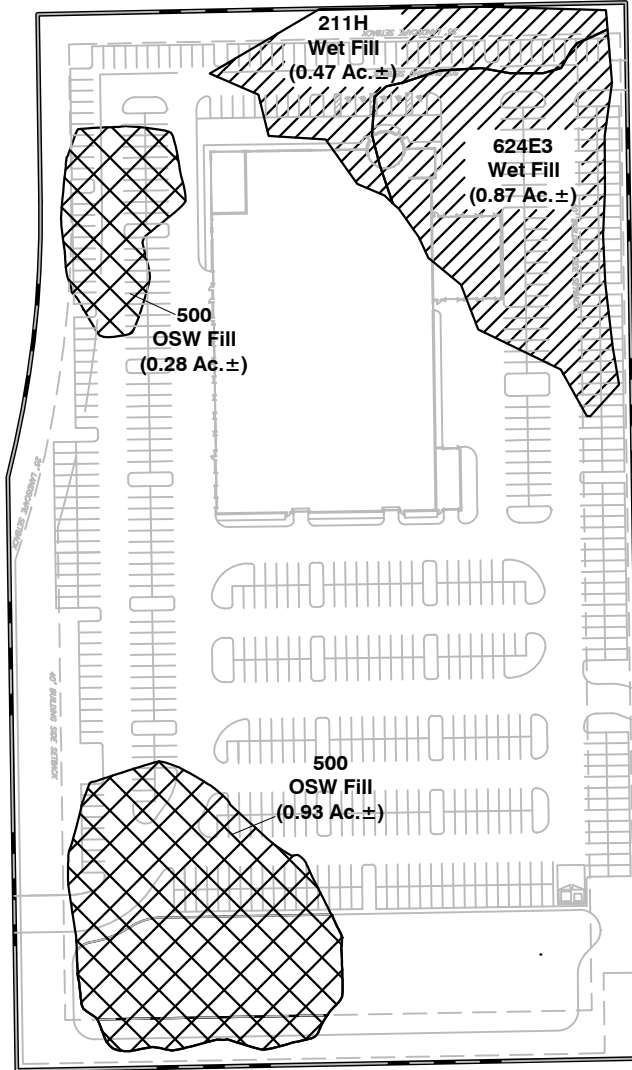

**Legend**

- Wetland Fill**  
(1.34± Ac.) (4,324 CY Fill)
- Other Surface Water Fill**  
(1.21± Ac.)

**Impacts**

FLUCFCS Code	Community	Wetland Fill	OSW Fill
211 H	Improved Pasture, Hydric	0.47 ± Ac	-
500	Water	-	1.21 ± Ac
624 E3	Cypress/Pine/Cabbage Palm	0.87 ± Ac	-
<b>Total</b>		<b>1.34± Ac</b>	<b>1.21± Ac</b>

**NOTES:**

FLUCFCS lines estimated from 1"-200' aerial photographs and locations approximated.

FLUCFCS per Florida Land Use, Cover and Forms Classification System (FLUCFCS) (FDOT 1999).

Site plan was acquired from Freeland and Kauffman, Inc Drawing No. Ft. Myers Site.dwg and was received 2/16/15.

C:\Users\Briann\appdata\local\temp\AcPublish\_7336\Base Maps.dwg Tab: Impact by FLUCFCS Nov 01, 2016 - 11:26am Plotted by: briann

Category	Drawn By:	Date:	Scale:
Impact	B.K.M.	11/1/16	1" = 150'
Agency	Job Number	County	
---	2014-52	Lee	
App/Permit No.	Revision	S/T/R	
***		6/45S/25E	

**Colonial Plantation  
Dealership**  
Impact by FLUCFCS Map

11000 Metro Parkway  
Suite 4,  
Ft. Myers, FL 33966  
Phone: (239) 418-0671  
Fax: (239) 418-0672  
www.boylanenv.com







# WETLAND CROSS-SECTIONS

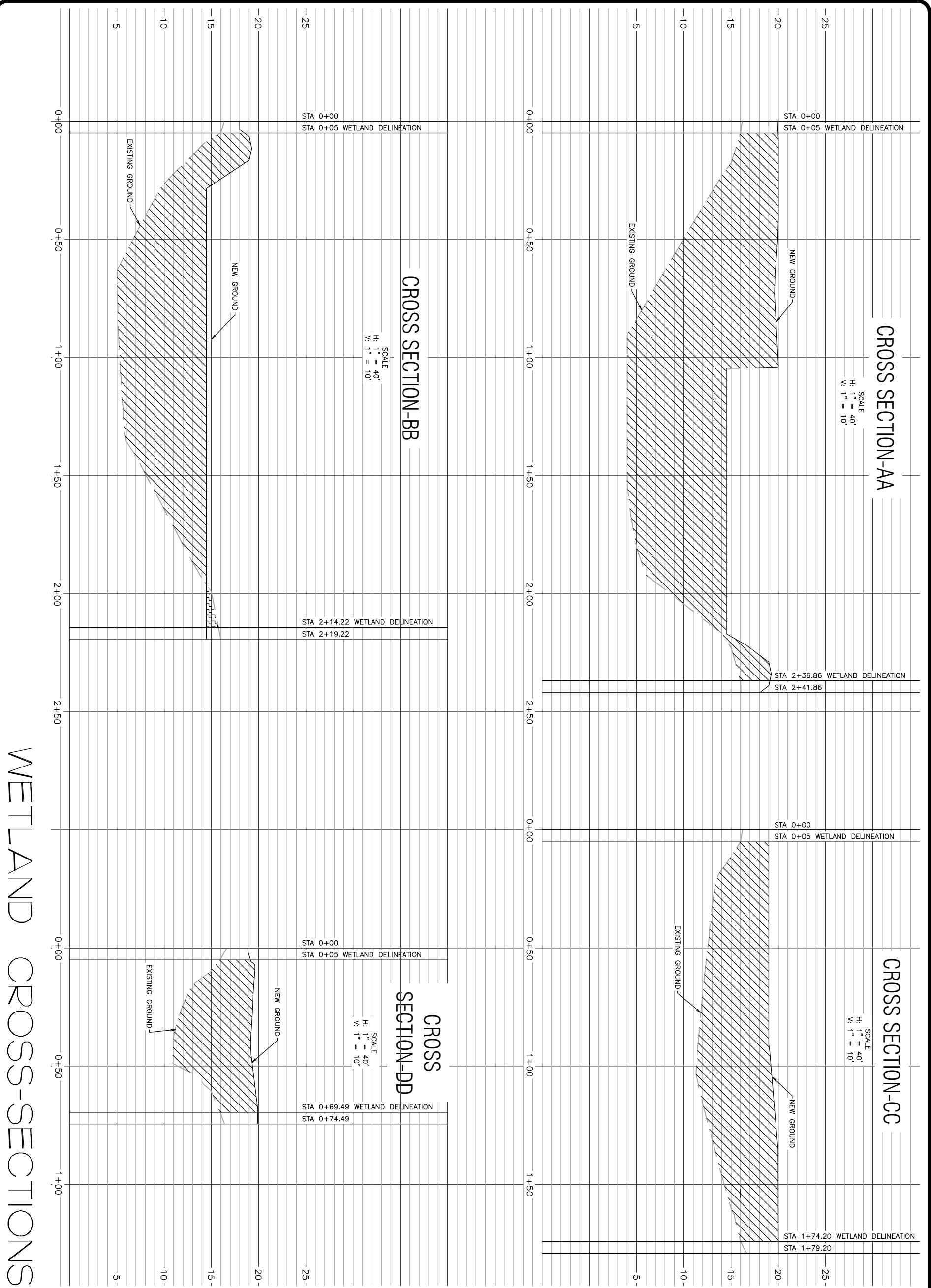

DATE  
10/10/2016

SONIC DEVELOPMENT, LLC  
4401 COLWICK ROAD  
CHARLOTTE, NORTH CAROLINA 28211  
MARTIN WALSH  
704-566-3980

FREELAND and KAUFFMAN, INC.  
Engineers \* Landscape Architects  
209 West Stone Avenue  
Greenville, South Carolina 29609  
PHONE 864-233-5497  
FAX 864-233-8915

# WETLAND CROSS-SECTIONS

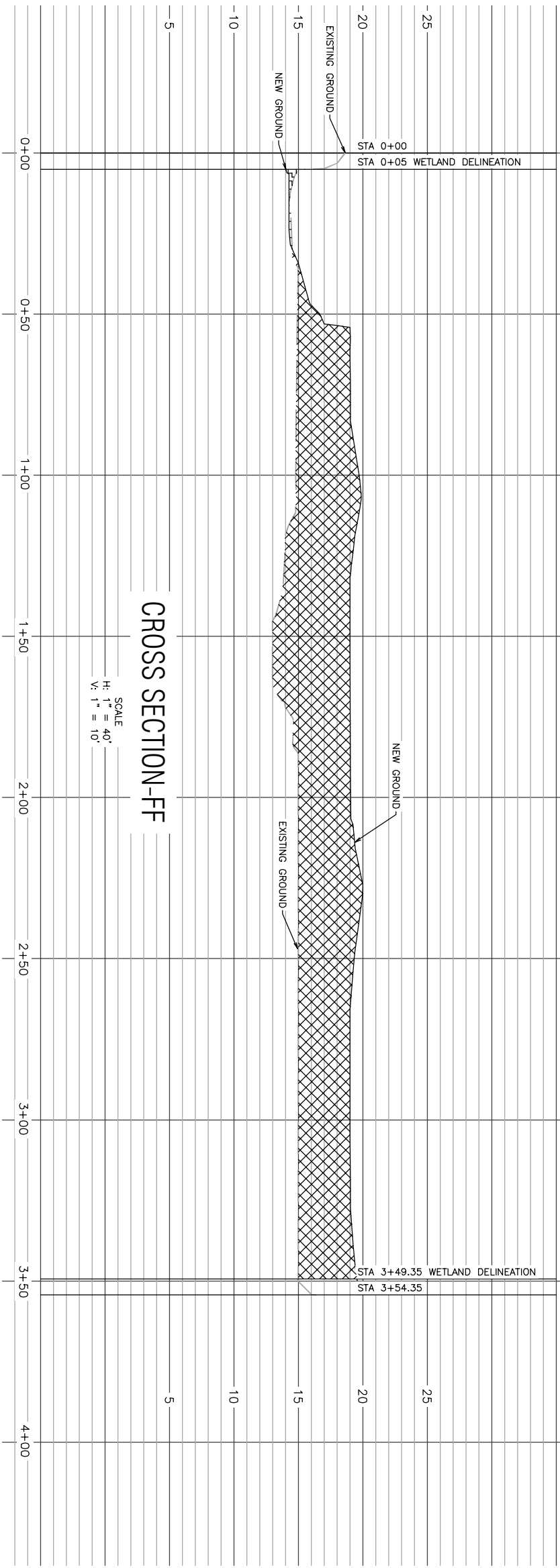
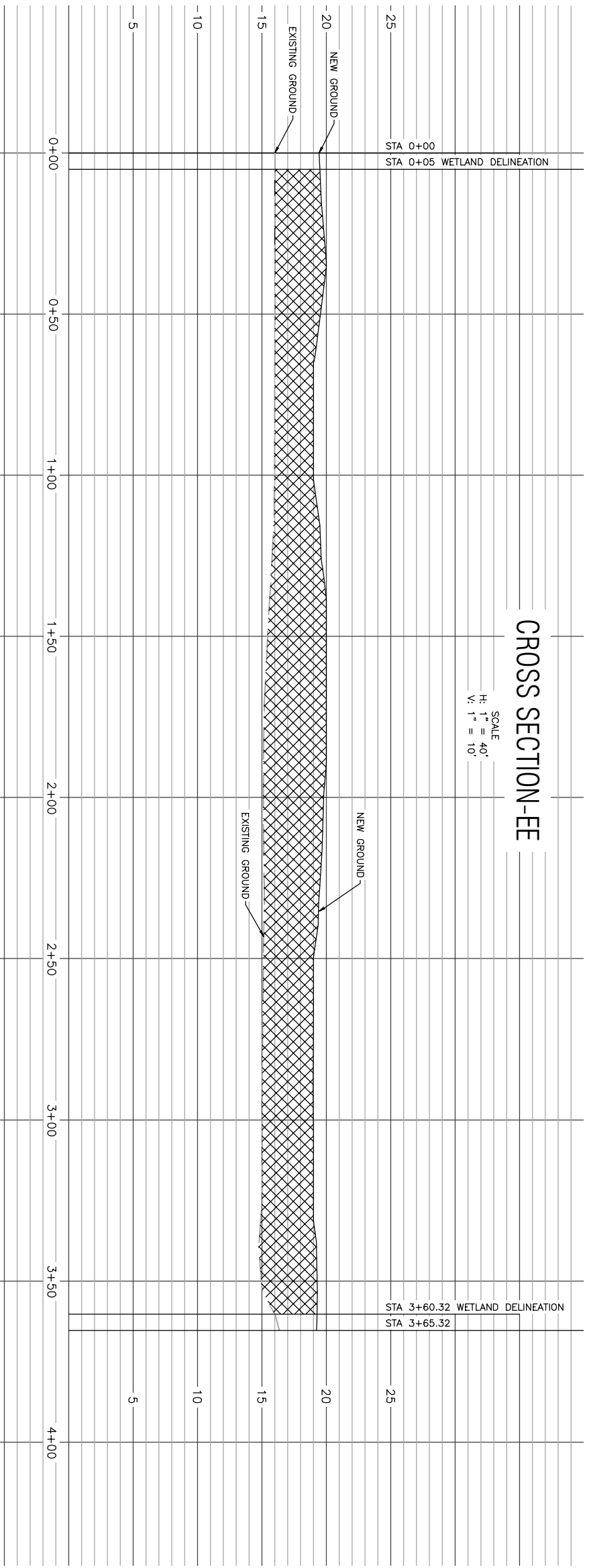

**FREELAND and KAUFFMAN, INC.**  
 Engineers \* Landscape Architects  
 209 West Stone Avenue  
 Greenville, South Carolina 29609  
 PHONE 864-233-5497  
 FAX 864-233-8915

**SONIC DEVELOPMENT, LLC**  
 4401 COLWICK ROAD  
 CHARLOTTE, NORTH CAROLINA 28211  
 MARTIN WALSH  
 704-566-3980

DATE  
10/10/2016